

*A Reflection on the Sublime*

A group exhibition conceived by Kazuna Taguchi with structured by Soshiro Matsubara

Hiroshima City Museum of Contemporary Art

1. Trisha Donnelly  
*Untitled*  
2016  
Digital video, projection  
Dimensions variable  
Collection of the artist

2. Le Corbusier: The Chapel of Notre-Dame Du Haut (1955) at Ronchamp, France [Model] scale 1/50  
Production: Kyoto University, Faculty of Engineering, Department of Architecture, 3rd Year+ graduate student, Kato Laboratory  
37.5 x 105 x 74 cm  
Collection of Hiroshima City Museum of Contemporary Art

3. Kazuna Taguchi  
*Floating*  
2024  
Gelatin Silver Print  
Dimensions variable  
Collection of the artist

4. Kazuna Taguchi  
*Appearance Through the Drape*  
2023  
Gelatin Silver Print  
19.4 x 14.1 cm  
Collection of the artist

5. Arman  
*Resurrection*  
1985  
Bronze  
73.5 x 46 x 39 cm  
Collection of Hiroshima City Museum of Contemporary Art

6. Ryusei Kishida  
*Two Reikos (Little Girls Fixing Their Hair)*  
1922  
Oil on canvas  
100 x 80.3 cm  
Collection of Sen-oku Hakukokan, Tokyo

7. Emilia Wang  
*Blessed Leap*  
2023-24  
Printed book  
18.8 x 12.8 cm

8. E'wao Kagoshima exhibition catalogue  
31.3 x 31.3 cm  
1976  
Printed matter  
Private Collection

9. Anthony Caro  
[Model]  
c.1991  
Plastic  
10 x 10 x 10 cm  
Collection of Museum of Contemporary Art Tokyo

10. Tomio Miki  
*EAR*  
1969  
Aluminum

30 x 22 x 8.5 cm  
Collection of Hiroshima City Museum of Contemporary Art

11. Joanne Kyger  
*Descartes*  
1968  
Video

11min 14 sec  
Collection of UC Berkeley Art Museum & Pacific Film Archive

12. Atsuko Tanaka  
*1985-7*  
1985  
Ink, pencil on paper  
109.3 x 78.8 cm  
Private collection

13. Seiichi Furuya  
*Wien 1984*  
1984  
Gelatin Silver Print  
37.2 x 24.7 cm  
Collection of the artist

14. Kunitaro Suda  
*Peony*  
1941  
Oil on canvas  
40.9 x 53.0 cm  
Collection of Uehara Museum of Art

15. Nancy Lupo  
15-1. *Closer to Faces*  
2024  
Porcelain Kronleuchter from Germany mostly probably Weimar era or mid-century / East German, steel fence post stakes from various locations in Hiroshima (5 units)  
17.5 x 150 x 34 cm, 18 x 265 x 14 cm, 14.5 x 398 x 39 cm, 14 x 150 x 27.5 cm, 12.5 x 169 x 25 cm

15-2. *Tina*  
2024  
Stainless steel, nylon, Onahole, plastic motor and battery  
50 x 10 x 10 cm

15-3. *Oona*  
2024  
Stainless steel, nylon, Onahole, plastic motor and battery  
50 x 10 x 10 cm

15-4. *Louise*  
2024  
Stainless steel, nylon, Onahole, plastic motor and battery  
50 x 10 x 10 cm

15-5. *Becky*  
2024  
Stainless steel, nylon, Onahole, plastic motor and battery  
50 x 10 x 10 cm

15-6. *Untitled*  
2024  
White, cream, off-white and gray polyester-silk rose petals  
Dimensions variable

15-7. *New Numbers*  
2024  
Toilet paper (Italian, German and Japanese brands), iridescent "Space Gelb" pigment, matte medium, balsa wood, graphite and fly fishing string (2 units)  
11 x 43 x 57 cm, 12 x 43 x 58 cm

15-8. *Untitled*  
2024  
Battery powered candles and cardboard box  
20.5 x 26 x 22 cm  
Collection of the artist

16. Patricia L. Boyd  
35888  
2018  
Gelatin silver photograms  
181 x 412 cm  
Collection of the artist

17. Alan Longino  
*Sublime (Three, (3)); [NRAS c.182A>G, p. Q61R (NM\_002524.5) (VAF: 3696)]*  
\*Title is subject to change as author's DNA changes.  
2024  
Three texts on paper, plastic Rx bottle, Apricot kernels (boiled)  
Ed. 1/1  
Dimensions variable  
Collection of the artist

18. Henry Moore  
*Reclining Figure: Bone Skirt*  
1977  
Bronze  
12.5 x 24.5 x 16 cm  
Collection of Hiroshima City Museum of Contemporary Art

Measurements are height before width for two dimensions and height before width and depth for three dimensions.

19. Kurt Schwitters  
*Little Dog*  
1943-44  
Stainless steel  
41.9 x 21 x 17 cm  
Collection of Hiroshima City Museum of Contemporary Art

20. Jean Arp  
*Profil*  
1955  
Bronze  
31 x 13.5 x 19 cm  
Collection of Hiroshima City Museum of Contemporary Art

21. Klemet  
Title and year of production unknown  
28.1 x 24.8 cm  
Collection of Haus der Matsubara

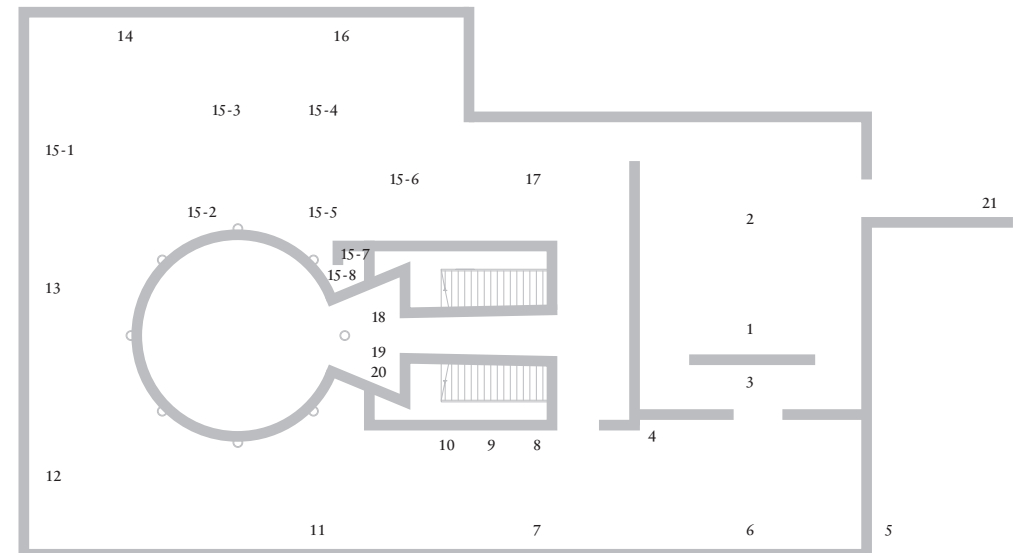

## Jean Arp

[1886-1966: Born in Strasbourg, France. Died in Basel, Switzerland.]

“Art is of natural origin and is sublimated and spiritualized through the sublimation of man.” “I wanted to create new appearances, extract new forms from man.” (Jean Arp, *On My Way*, 1948)

## Arman

[1928-2005: Born in Nice, France. Died in New York, US.]

A work of violin accumulations, developed from the slicing of violins, saxophones, and other instruments by the impulse toward abusive destruction caused by “anger (colère)”.

## Joanne Kyger

[1934-2017: Born in Vallejo, California, US. Died in Bolinas.]

Kyger made the only video work of her life, *Descartes*, in 1968, along with her poem “Descartes and the Splendor of A Real Drama of Everyday Life. In Six Parts” based on Descartes’ *Discourse on the Method*. In this video work, she develops an ontological argument about the “Mother God” who “created everything”.

## E’wao Kagoshima

[1945– : Born in Niigata, Japan. Based in New York, US.]

An exhibition catalogue published on the occasion of Kagoshima’s solo exhibition at Nagai Gallery (February 12-25, 1976), prior to his moving to the US. It shows that the exhibition included surrealist oil paintings with fine line drawings, objects, and prints.

## Anthony Caro

[1924-2013: Born in New Malden, UK. Died in London.]

A model formerly owned by Shigeo Anzai. It is reminiscent of the architectural sculptures that Caro named “Sculpitecture,” which can be experienced by entering the interior of the work's space.

## Ryusei Kishida

[1891-1929: Born in Tokyo, Japan. Died in Yamaguchi.]

In 1917, Kishida moved to Kugenuma, where he recuperated from pulmonary tuberculosis, and began a series of “Reiko Portraits” modeled after his beloved daughter, Reiko. *Two Reikos (Little Girls Fixing Their Hair)* is known as the only oil painting with a surrealist composition depicting two Reikos, and marks a turning point toward “Oriental beauty” after exploring “inner beauty” through watercolors.

## Klemet [Unknown]

Details unknown. Collection of “Haus der Matsubara”.

## Kurt Schwitters

[1887-1948: Born in Hannover, Germany. Died in Kendal, UK.]

Schwitters’ sculptures, which have taken on increasingly organic shapes since the late 30s, are fused with constructivist elements in this work, created after his exile in England in 1941 and titled in English as “Little Dog”.

## Kunitaro Suda

[1891-1961: Born in Kyoto, Japan. Died in Kyoto.]

After a lifetime of exploring the theory and practice of painting, Suda’s *Peony* can be said to be one of the culmination of his efforts as a Japanese painter to “integrate Eastern and Western painting” after his return from four years of study in Spain. When painting peonies, he went to the Kyoto Botanical Garden near his home.

## Kazuna Taguchi

[1979– : Born in Tokyo, Japan. Based in Vienna, Austria.]

Taguchi discovers metaphysical presences in time and space through monochromatic works with multi-layered structures (–Adapted from A *Quiet Sun* press release). *Floating* was made by shifting and overlapping two sheets of film taken in 2009, inverting them and exposing them for an extended period of time.

## Atsuko Tanaka

[1932-2005: Born in Osaka, Japan, Died in Nara.]

A monochromatic drawing developed from a wiring diagram for *Electric Clothes* presented at the 2nd Gutai Art Exhibition (1956). The antagonistic relationship between the circle and the line creates a fluid energy.

## Trisha Donnelly

[1974– : Born in San Francisco, US. Based in New York.]

## Seiichi Furuya

[1950– : Born in Shizuoka, Japan. Based in Graz, Austria]

*Wien 1984* is a portrait of his wife, Christine Furuya Gessler, taken at their apartment in Margaretenstraße, Vienna. The negative film, shot on Polaroid Type 55, shows traces of chemical changes on the edges.

## Patricia L. Boyd

[1980– : Born in London, UK. Based in London]

35888, is a photogram that captures light in close contact with the glass of a bus shelter in North Melbourne. Made at night by incidental light, the work records dirt, graffiti, scratches, dust and traffic on the glass surface.

## Tomio Miki

[1937-1978: Born in Tokyo, Japan. Died in Kyoto]

“I believe that ears do not exist based on a relative relationship with the self who chose them, but rather exist from the position of self-denial, that the ears have chosen me.” (“Responses to the Questionnaire (Special Feature: Body Art)” *Bijutsu Techo*, 1965, No. 258, October)

## Henry Moore

[1898-1986: Born in Castleford, UK. Died in Perry Green, Hertfordshire.]

“There are three fundamental poses of the human figure. One is standing, the other is seated, and the third is lying down ... of the three poses, the reclining figure gives most freedom compositionally and spatially.”

(Adapted from J.D. Morse, ‘Henry Moore comes to America’, *Magazine of Art*, 40, no. 3, 1947).

## Le Corbusier

[1887-1965: Born in La Chaux-de-Fonds, Switzerland. Died in Roquebrune-Cap-Martin, France.]

A model of the Chapel of Notre-Dame Du Haut in Ronchamp on a small hill in the Bourgogne-Franche-Comté region of eastern France, completed in 1955. Light diffuses into the interior through colored glass from multiple openings in the south wall, creating a sacred space of light and shadow.

## Nancy Lupo

[1983- : Born in Flagstaff, Arizona, US. Based in Los Angeles and Berlin, Germany.]

*Closer to Faces* (2024) is the third and final iteration in a trio of works including *Dying Play* (2022) and *...* (2023). The works serve as a meditation on the way in which emotional states like dread or wistfulness become embedded into objects and infrastructure that is encountered in everyday life. Amongst other materials, the sculptures present here incorporate Weimar Germany era porcelain candelabras sourced near the artist’s home in Berlin and steel “pig tail posts” found currently in use in various locations on the streets of Hiroshima.



## Alan Longino

[1987- : Born in Biloxi, Mississippi, US. Based in Chicago.]

Art historian and curator. He is a Ph.D. student at the University of Chicago focusing on postwar Japanese conceptual art. His research considers the artist Yutaka Matsuzawa and the artist’s approach to a dematerialized practice that was hinged upon a system of quantum physics, non-Zen Buddhism, and para-psychology. He is the founder of Longino, I.A.H. The title of the exhibit *Sublime (Three, (3))*; [NRAS c.182 A>G, p. Q61 R (NM\_002524.5) (VAF: 36 %)] is in sync with the author’s DNA changes.

## Emilia Wang

[1994- : Born in Canada. Based in Tokyo.]

*Blessed Leap* is a booklet of collected writing from 2023-2024. The title comes from a quotation attributed to unnamed poet from Soren Kierkegaard’s *Fear and Trembling*.

\*If you would like a copy of Emilia Wang’s work, please ask a staff member. Please note that we only have a limited number.

March 30 – June 9, 2024

Organized by:  
Hiroshima City Museum of Contemporary Art

Sponsored by:  
Federal Ministry Republic of Austria Arts, Culture, Civil Service and Sport,  
Austrian Cultural Forum

Under the auspices of:  
Hiroshima Prefecture, Hiroshima Municipal Board of Education,  
The Chugoku Shimbun, The Asahi Shimbun,  
The Mainichi Newspapers, The Yomiuri Shimbun,  
RCC Broadcasting Co., Ltd., TSS-TV Co., Ltd.,  
Hiroshima Television Corporation,  
Hiroshima Home Television Co., Ltd.,  
Hiroshima FM Broadcasting Co., Ltd., Onomichi FM Broadcasting Co., Ltd.

With the cooperation of:  
Air de Paris, Fondation d’entreprise Hermès,  
Uehara Museum of Art



